

# Writings In The Sheep Shed



Felix BOB  
JOE  
Raeb A. Mestas  
Sharky  
Manuel



By  
Judi Myers

© 2005

## Writings In The Sheep Shed

By

Judi Myers

August, 2005

Since ancient times, man has had a special – even spiritual – relationship with sheep. In the season loosely called ‘Spring’ in Sublette County, the sheep are sheared. The fluffy wool is cut off, compressed, baled and shipped.

While the shearers are busy giving 100 ‘haircuts’ each day, the herders have a great deal of quiet time. Wherever there are wooden sheds to protect the waiting flock these men have carved, painted and drawn their names, pictures, and poems on the walls. Recording them in the dark, non-electrified buildings can be both tedious and rewarding. Preserving them means saving a small piece of history.

The Magagna family has been in the sheep business since 1907. Jim Magagna, Vice-President of Wyoming Stock Growers Association, has run the ranch since 1964. On a remote, bumpy road in the southern part of the county his sheep shed looks and functions much as it did in his grandmother’s day. Before lambing, Magagna’s 1500 ewes are brought in to await the shearers. The long pens are packed with about half his sheep at one time. Their bells have been removed and hung on a beam. The quiet is eerie. Unlike cows bawling at a branding, sheep are just as the Bible says: quiet “as a lamb is silent before the shearers” (Acts 8:32 & Isa 53:7).

For the first half of the 1900s the shearing was done by hand with squeeze type shears and the shed was divided into multiple pens. When electric clippers came into use in the late 1940s, the shed was remodeled into fewer but larger pens. Ceiling boards held the cords, which ran to an outside generator.

The electric shears created a new problem. Sheep were dying from tetanus. They’d be nicked and cut from the vibrating clippers and then be turned out where manure caused infection. Spaced, wooden floors were added in the 1960s and eliminated the problem by allowing manure to drop through to the ground.

Another change came when shearers began bringing their own shearing trailers. Although the shed is still used to hold the ewes, they go outside through a narrow chute and into the portable trailer to be clipped. A man with hand blades could shear 80-100 head/day. Modern shearers can clip 150. In the early days 28-32 fleeces were rolled up, then stomped (or tromped) into 15 foot bags. Now the wool from 50 sheep can be compressed into bales that weigh close to 500 pounds.

Near the sheep shed are the collapsing log cook cabin and bunkhouse, used in the days before shearers brought their own campers. These walls also have writings. Names from New Mexico are Magagna’s sheep herders and truck drivers. Until the mid-1950’s nearly all the herders were Mexican-Americans. From then through the 1980’s the majority were Basque, then Chinese and currently Chileans. Many shearers were from Texas. The blue chalk on the walls was a marker for dry ewes.

Magagna’s Sheep Shed Writings were recorded in 2004-2005 by Lynn Thomas, Karen Root and Judi Myers. Photos were taken by Lynn and Judi. The oldest date found was 1919 on Panel 26. This story is in the sketches that accompany this introduction.

# Writings In The Sheep Shed

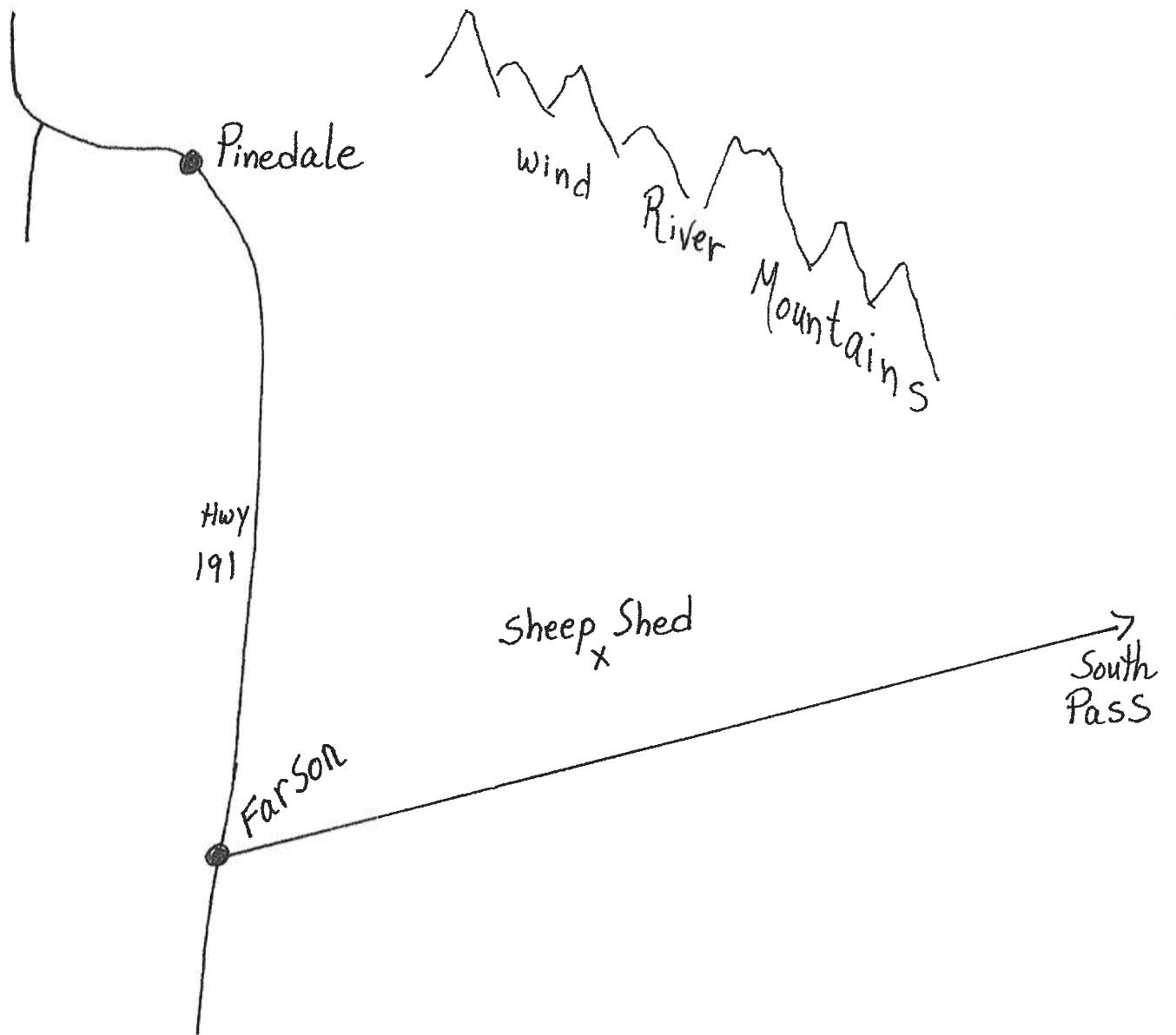

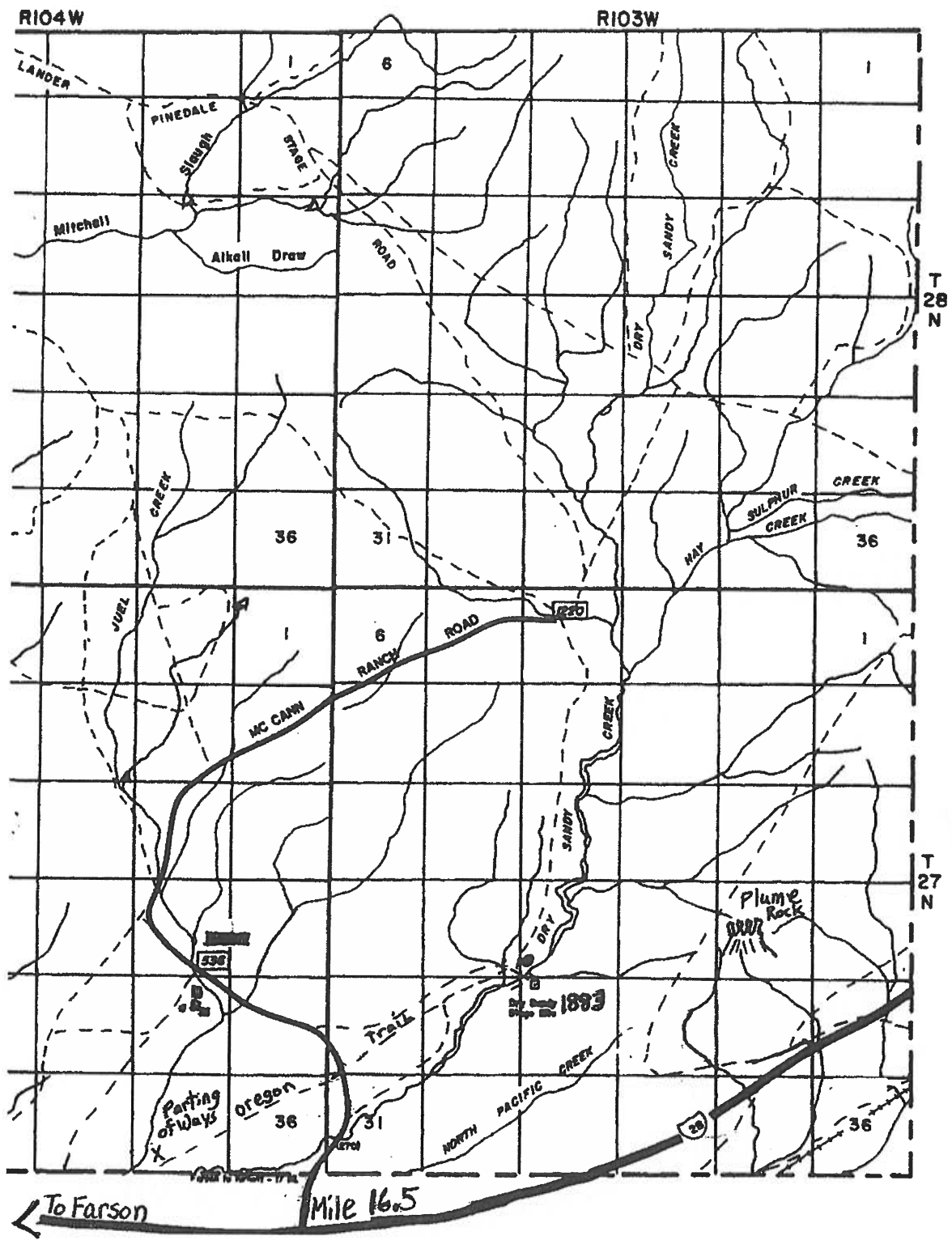

**536** = Magagna  
 Sheep Shed  
 Cook Cabin  
 Bunkhouse



# Magagna Sheep Shed Floor Plan to "Writings In The Sheep Shed"

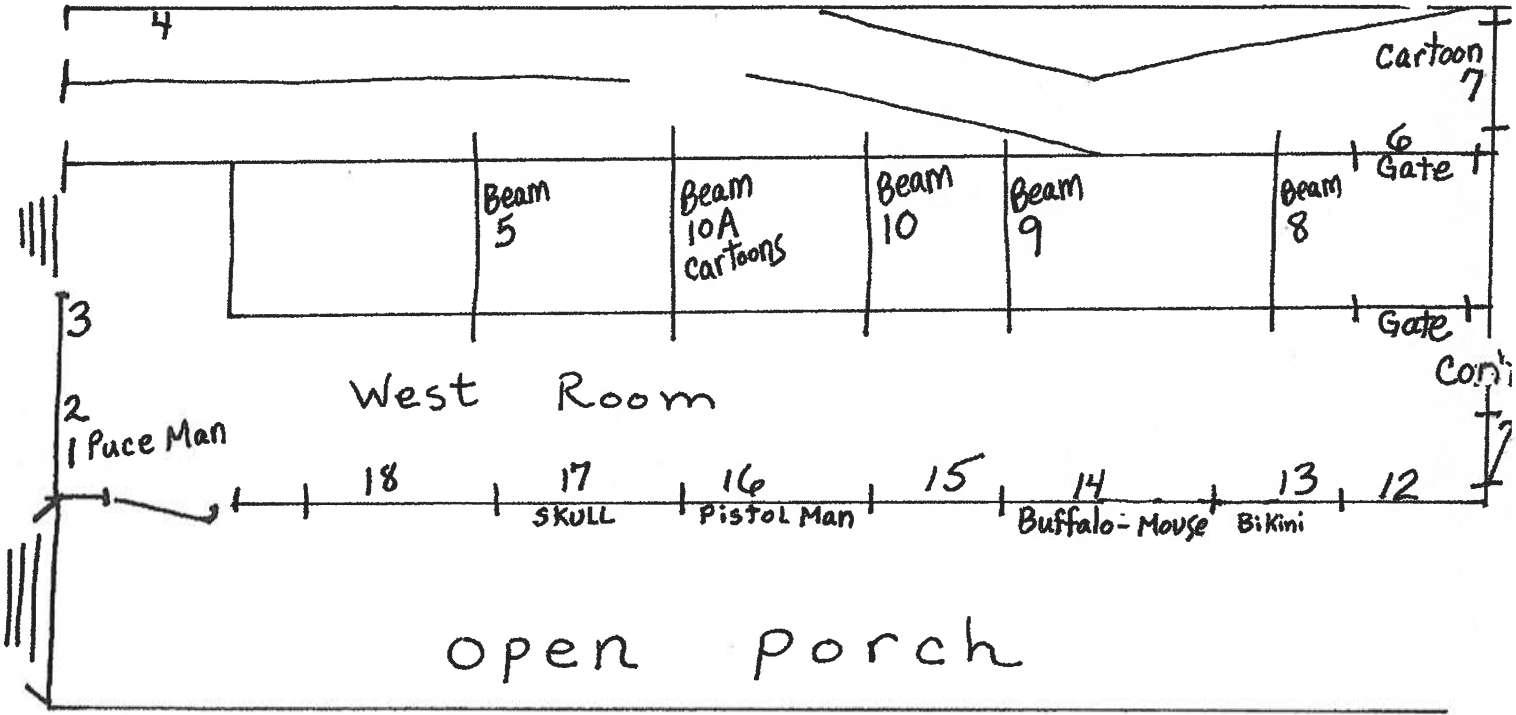

2nd Room From West.  
Connects to  
"West Room"  
at "Con't"  
Wall

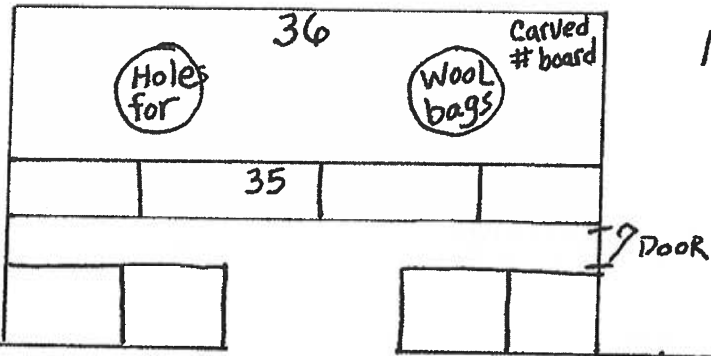

Not to Scale

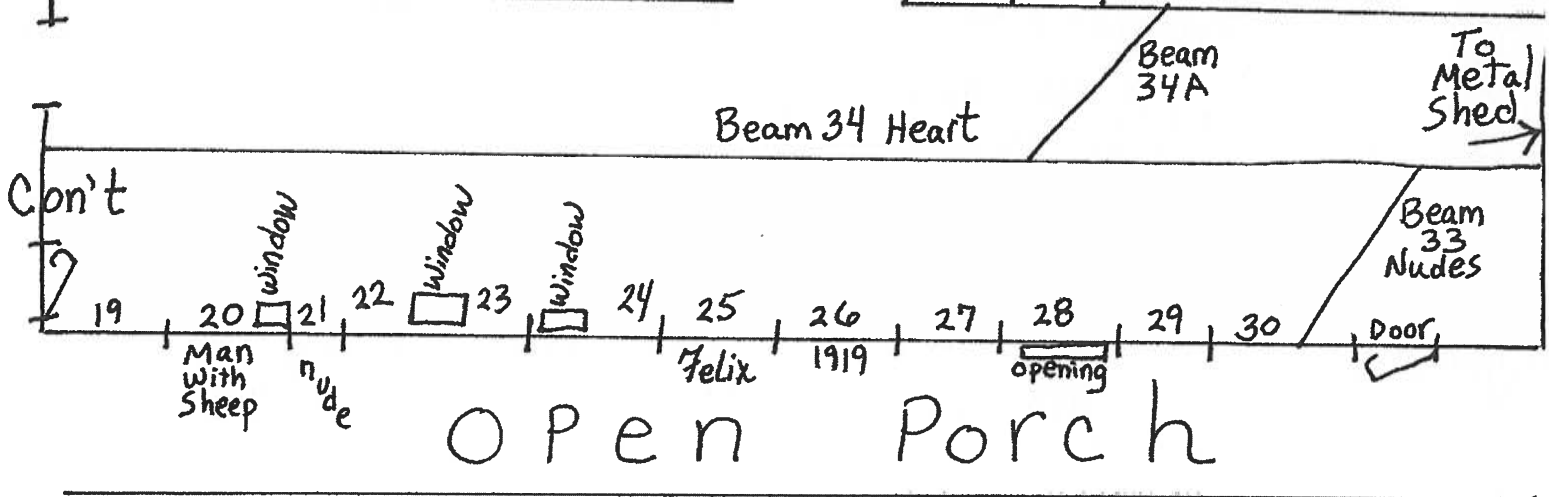

JM  
105

Magagna Sheep Shed  
West Wall #1



1971

1971

Head is puce-  
green marker.  
Suspenders are  
red. Numbers  
are white.

lt Copier

Magagna Sheep Shearing Shed  
North + West Walls

MOUCE  
97CE

#2  
blue  
chalk

210169  
CHAVILLE

S K T A

#4 BLUE

#7 Beam

Victor Chavez  
May 3

1948

972

6832

37

18

87

Joe Gordon  
64 4??  
45 Jack

B L L B C

#4 North Wall

#2 Blue Chalk

West wall #3

92 → FRANK  
MOPY  
4394 97  
95

NEERT  
5 76 80

← Beam 5

COBZILIA

Jim Recorder

Magayna sheep me  
East Wall of West Room  
Upper beam # 7



At Recorder



Magagna Sheep Shed  
Beam 8



At Recorder

A. Mestas

May 5, 1937

A

Albert Mestas

19 <sup>mm</sup> 37 and 38 and 39

John Shuster

May 6 1935

Magagna Sheep Shed  
Beam 8



It copier

Magagna Sheep Shed  
Beam 8  
↓

*Las Estas*

#6 Gate Blue Paint  
↓

E/5/11  
LAS  
ESOTEX,  
TOM GREEN

Beam 9  
↓

*Las Estas* May 7, 1939  
Bob Vincent was here  
1927 → the 4 day  $\frac{7}{2}$  -

Panel 11  
↓

Beam 10 ↓  
ALEJANDRE  
GONZALEZ  
FORT COLLINS  
Colo.

9 m m Pell'an la  
Bob Vincent  
April 6, 1957  
AT  
FARSON WYO  
Casper Wyo  
Shanky Cordova  
Manuel Piro  
merc  
Fronnele  
Dino

lt recorder

Beam 10A



A

AB MAESTAS



East side of 3

Judi  
2005

Panel 12

YEAD  
6-4-1939

May 56

Bernardo E Amigo

by Kelly

Frank Jones

BOB CORDOVA

Sharky  
Cordova  
Denver City  
Rom.

MAY 12 1932  
Valemo  
From Ranches  
of Texas Mex  
Mexico

At Recorder

+ JM

ty Shavkey Cordova TAKE SAME

7 or  
and

Rock Springs Wyoming

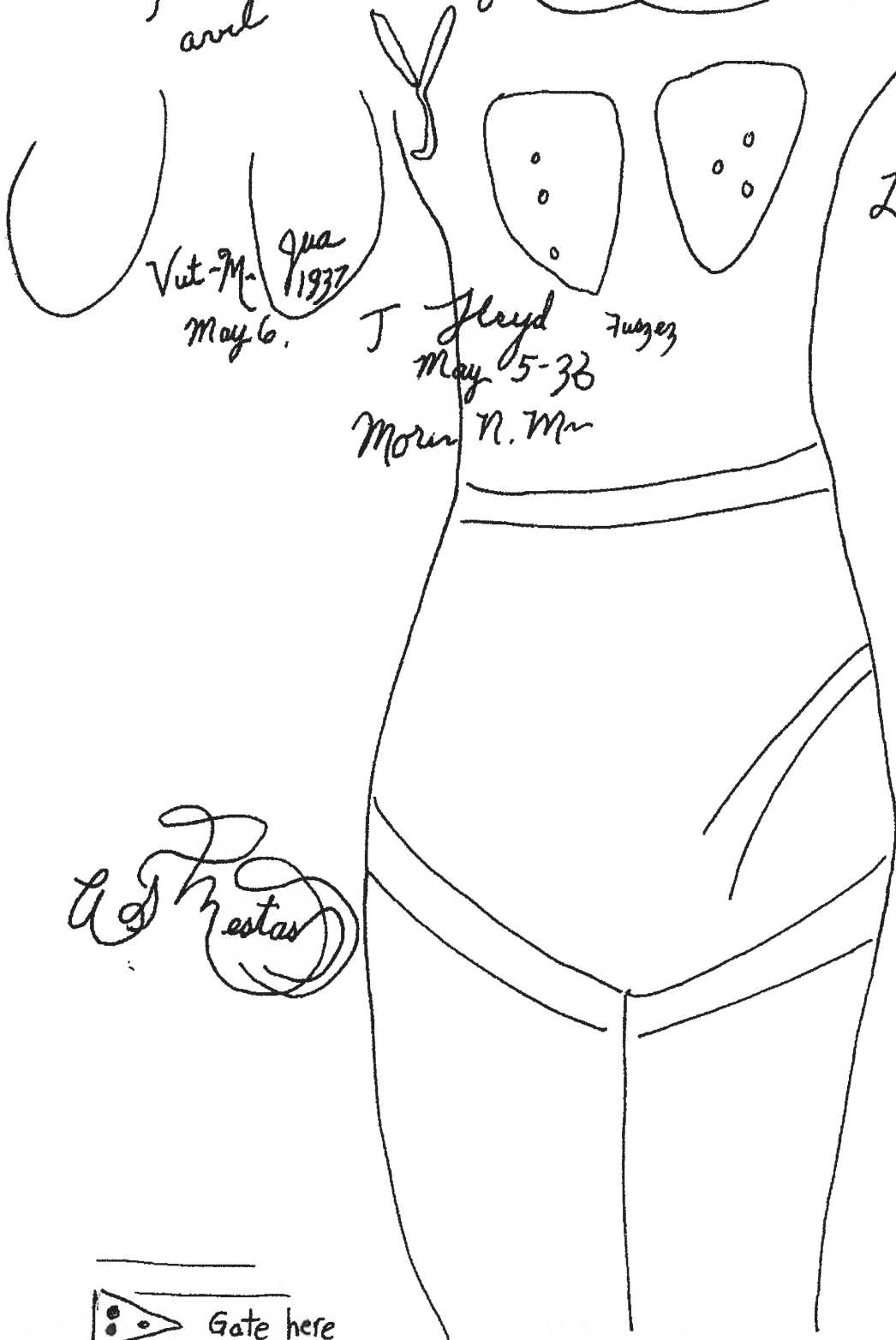

Vut-M-qua  
May 6. 1937

J Floyd Fuzer  
May 5-38  
Morn N. Mm

Los Angeles

	92	
	40	
	<hr/>	
◇ 9097		3680
10468		
4292	22	
3737	2772	
1123	1329	
	1217	
	<hr/>	
	684	
	<hr/>	
	4003	

778/131.4.26

Festas

Circles are  
bullet holes

lt Recorder

Gate here

Ceiling Board

DANIEL  
MALDOWADO  
MATINEZ,

MAY 16

1980

203

SHEEP

JOHN AGUIRRE.

May 4, 1946

JOE  
AGUIRRE

A Mestus  
Rock Spring Wyoming

Cacilio Arlega  
May 42 + 1936

Bob Vincent  
Rangling from  
April 5 to 16  
Bob Vincent

South Wall #12 Ceiling Board

May 2, H Rangling 2 3 4 5 6 7 8 9 11

Panel 14 Blue Marker

Fred Gallinas

Bob Cordova  
Diego

Jim  
Recorder

112 yagim sneep jncv  
South Wall -  
Panel 14

Jose A RAEL



May 3, 1948

Wavy lines pointing to a specific area on the face.

St Recorder



11  
666  
6  
666  
98

Thelma Valencia

Roberto  
Lopez

JOE Cordova  
Center, Colo  
Roy de los Capronos  
Fusuyo Hc-tlu

RECUERDOS  
DE UN AMICO.  
JUAN ARDEME

Francis  
Lujano  
Spring 639

Jose R  
Maestas  
5/17/59

30  
666  
666  
666  
666  
666  
3441

Tony  
M  
PENACVO

25  
48  
73  
30  
124  
47  
59  
13  
72

Truman Falls  
Idaho

Bob Cordova

Catoz

81  
51  
32



90  
82  
~~63~~

Dora

abe Martinez  
Cuz - Colo

168  
78  
88  
200  
329

Marel Pino

Leli

Bob  
Anderson  
Swynn

FA

474  
329  
863

8 8

South Wall #16



Diego Sava  
A Tucach

Bob Cordoy

The Wild  
Cowboy Vencer  
By Bob

May 9 1941

Raton  
Mex

KAR  
RECORDED

J. A. Rael 6/7/55-

40	
10	
31	
36	
<hr/>	
117	117
	40
<hr/>	
	46.80

Blue chalk  
↙

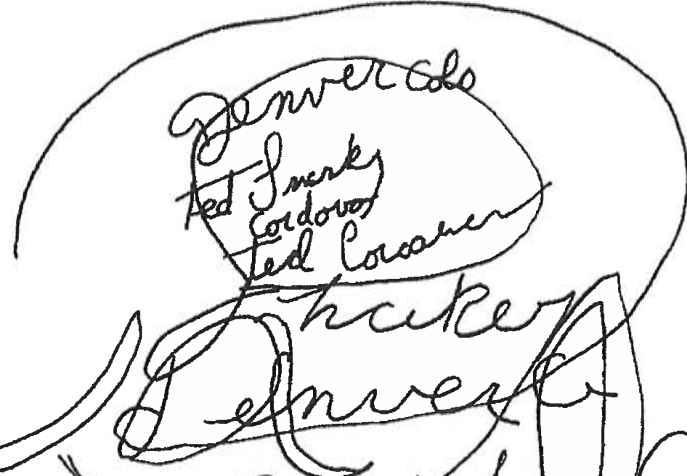

Blue chalk →

Bob Cordova  
Yarrow Cols

April 5  
61

← blue chalk

WIT  
~~TEW~~  
 LARR  
 BERN

WAYNE  
May 1995  
ALBERTI

Grubhaela  
BOB  
CORDOVA

Samuel  
Tono  
meccano  
Perryer n rest

JOE Frank  
Cordova  
Puppy

97

41
31
72

Frond abila  
from arcy  
Smarsel Pure

Hando  
New

Tony M

KFR  
RECORDER

South Wall 16/17  
Board H

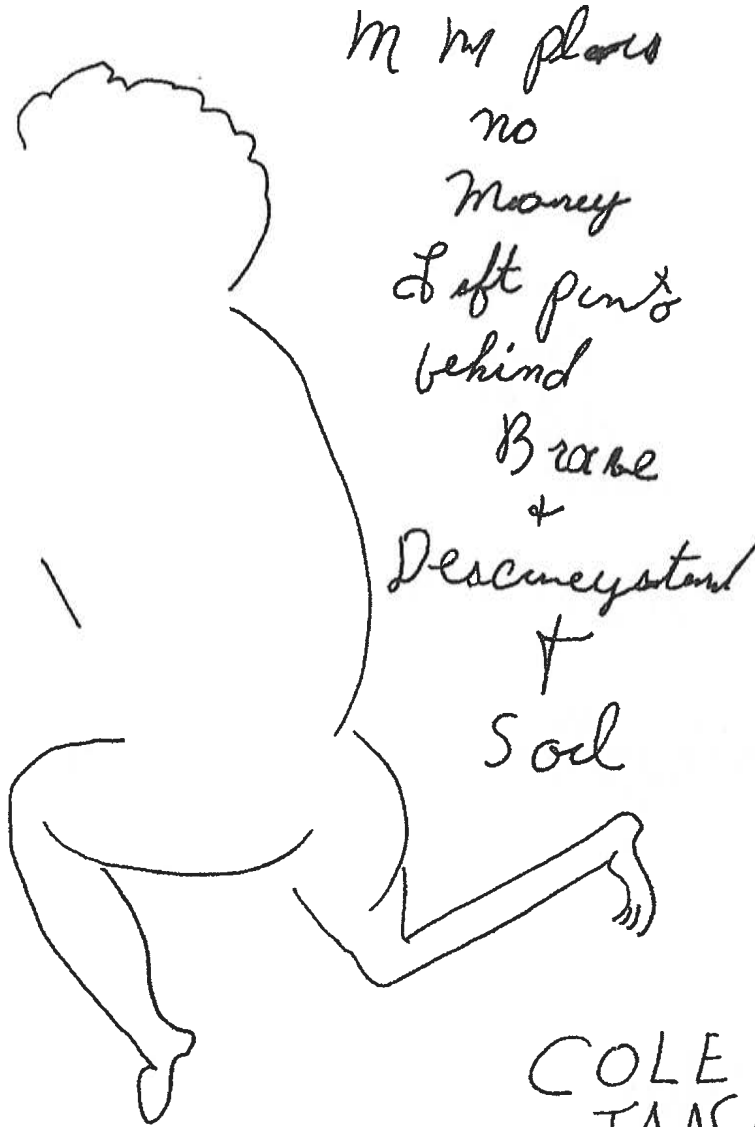

m m plans  
no  
money  
Left pants  
behind  
Broke  
+  
Discouraged  
+  
Sad

No ?  
money  
Left Pinto  
behind  
Broke  
+  
Discouraged  
+  
Sad

COLE Peterson  
JAN 6 2001  
Dad

Blue chalk across boards C-G

Bob Cordova

ROY BURK

OCT 7 2002

OCT 16 2003

Jane + Sanchez

PAT ↑

SILVER

Jim  
Recorder

Magagna Sheep Shed  
South Wall - Panel 17

CFIe'e

Jose Albina Hernandez  
Lio

Diego Nava

12) N° van  
CÓLTAS

Diego Cour  
all

Bob Cordova

May 9, 1900

Gar Garcia Colo



Jose Albino  
Fernandez

from Socater  
New Mexico  
Box 76

BOB CORDOVA

It recorder  
Am transcriber

Magagna Sheep Shed  
South Wall - Panel 17  
Upper Ceiling of Board A-B



At Recorder

TRUJILLO  
GRAND COLO  
JUNCTION

Adelard Panel 20  
Monday on  
Rancher esp  
Jaco New  
Mure

~~██████████~~ K This Guy

Charlie  
Snaf

~~Melito A Martone~~

BOB CORDOVA  
MAY 10, 1960  
ROCK SPRINGS

Eddie  
AGUIRE

Quealy  
WYOMING  
MAY 10, 1945



Frank Jones Panel 19  
John Aguirre



JM  
Recorder

4 > 8 = 56 EMBLE PASS  
TEXAS

Justin Moon

OCT 16 2003

JUSTIN B MOON

OCT 7 2002

Magagna Sheep Shed  
South Walls #17+21

Enrique Bernal

CEI'ee

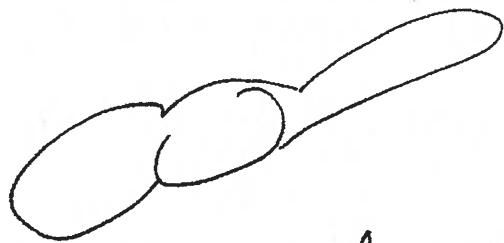

Bob Cordova  
was here

5-4-26

May 10, 1970

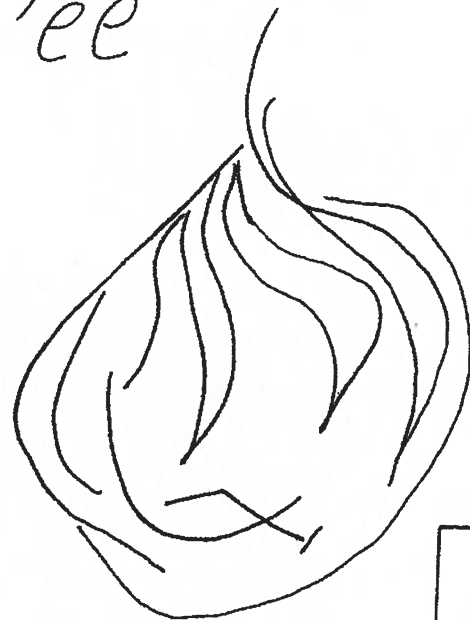

on  
upper  
Ceiling  
Board A-B  
nail in  
"mouth"

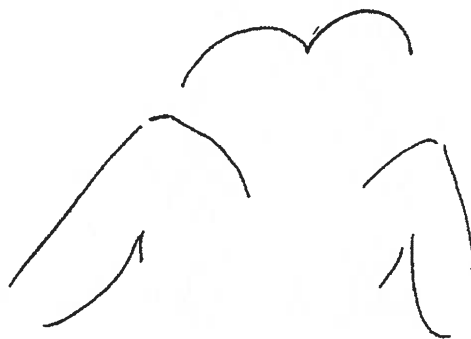

Blue  
Paint  
or  
Marker

Joe A. Fernandez

It's a copier



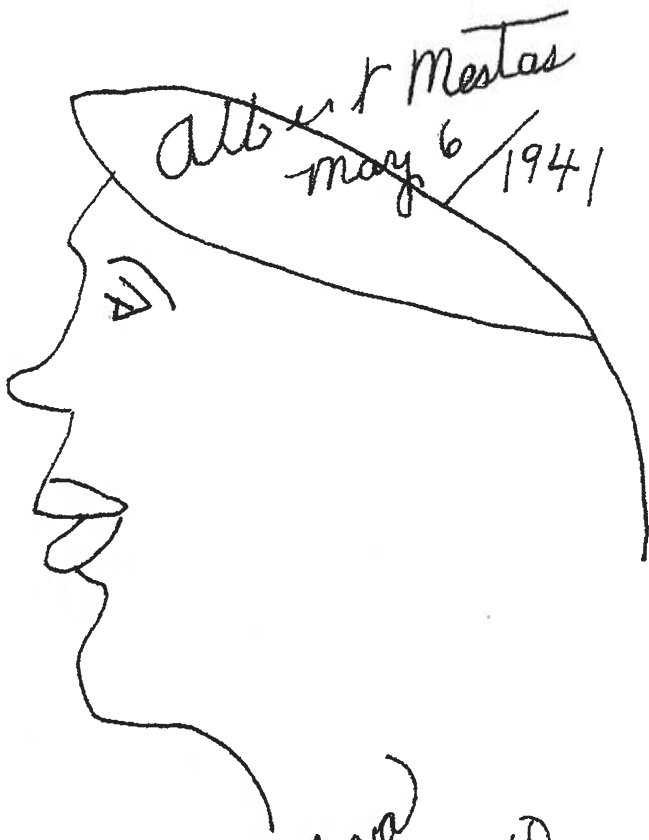

Albert Mestas  
May 6 / 1941

Bob Cordova  
+ Jane Sanchez

Bob Cordova  
age 19  
here May 19 1960



Meeting

Frank Jones

Bob Cordova  
May 1955

Bob Cordova  
was here  
May 10, 1960

Jose R. Mestas  
5:5:59

Panel →  
22 →

Bob



Go May

Recorder  
JM

George  
Ortiz.

yellow  
Chalk

Felix Chavez  
mur Yaas  
men

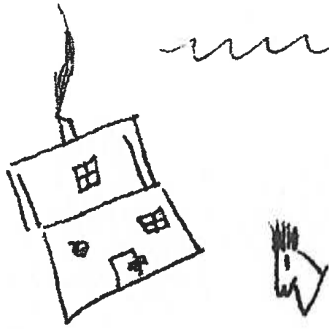

Drawings  
are close  
to actual  
size

Amando  
Mestas  
Mora New Mex  
May 10 1943

Charlie Swope  
Los Alamos Mexico  
May 12/61

Sharky Cordova  
tel Denver Colo  
m 15 1936



ARNOLD Trujillo  
May 15, 1958

Panel  
26 >

Ben  
Beez Samisterra  
Shaky May 5 1956  
Jrol  
Inocencio Paul  
Mayo 1, 1919

Recorder KR  
JM

← blue chalk

SHARKEY  
CORDOVA  
DENVER Colo  
MAYO 10 1961

Joe Teddy  
Sharkey Cordova  
May 5 1936

May 14, 1938  
All tracks Valerio  
Ranchos of 2 years  
New Mexico



Erzquiel  
Lopez

Crucho  
Traydie  
New Mex  
May 15, 1958

JOE AGUIRRE  
FT. LUPTON COLO

May 31 1939  
Frank Alulo  
Frank - g/kac

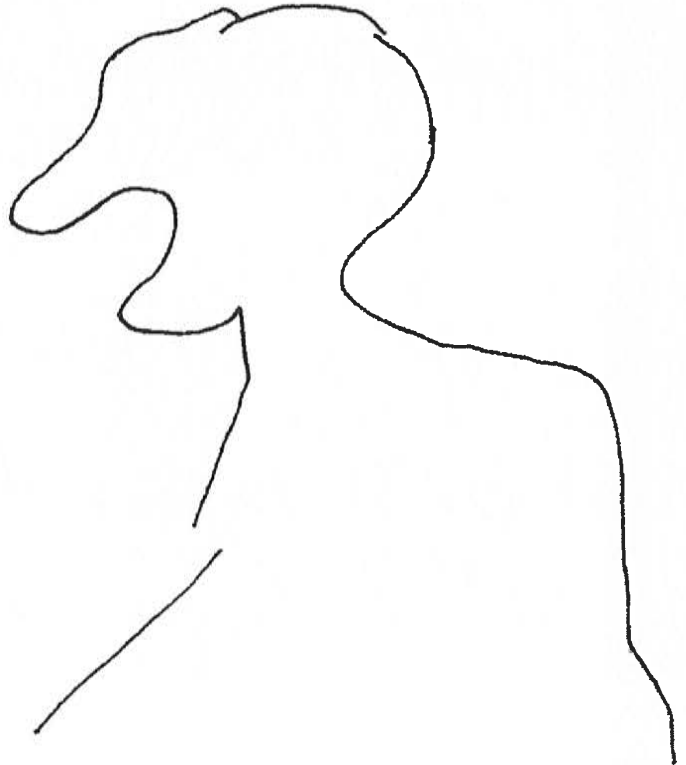

Jesse  
Madame  
Box 1143  
3-4 1991  
Constance



Recorder  
KR & JM

MAGAGNA SHEEPSHED  
PANEL 36

Red chalk  
↓

← Yellow  
chalk

HONORIO



Ronald  
90% Omaha  
1968

ERNEST J FIQUE

MAY 7 1950  
CENTER COLO

ROGER MEDINA  
FROM SAN POBLO  
MAY 2 1956  
←

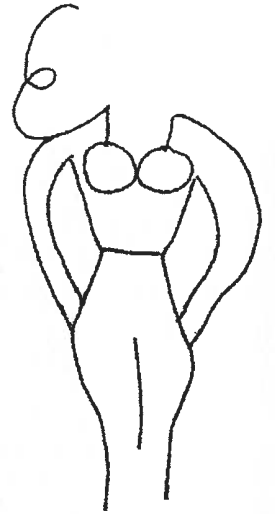

GILBERT  
VALADEZ

DE BROWNWOOD  
TEX

MAY 6 1963

LEONARD JOHNSON  
5 12 46

SONGS  
ONLY THE LONELY  
SOMETIME'S =

5/15/62 #29

Arnold Traylor  
Benosco New Mex

Paul Guitony  
JUNE 24  
5/2/25

Blue  
chalk

MAY 14 1958  
CAREDO  
PULVER  
RANCHOS JAZZ

SHARKEY  
CORDOYA  
DENVER COLO

Joe F  
Raton

Beam 33V

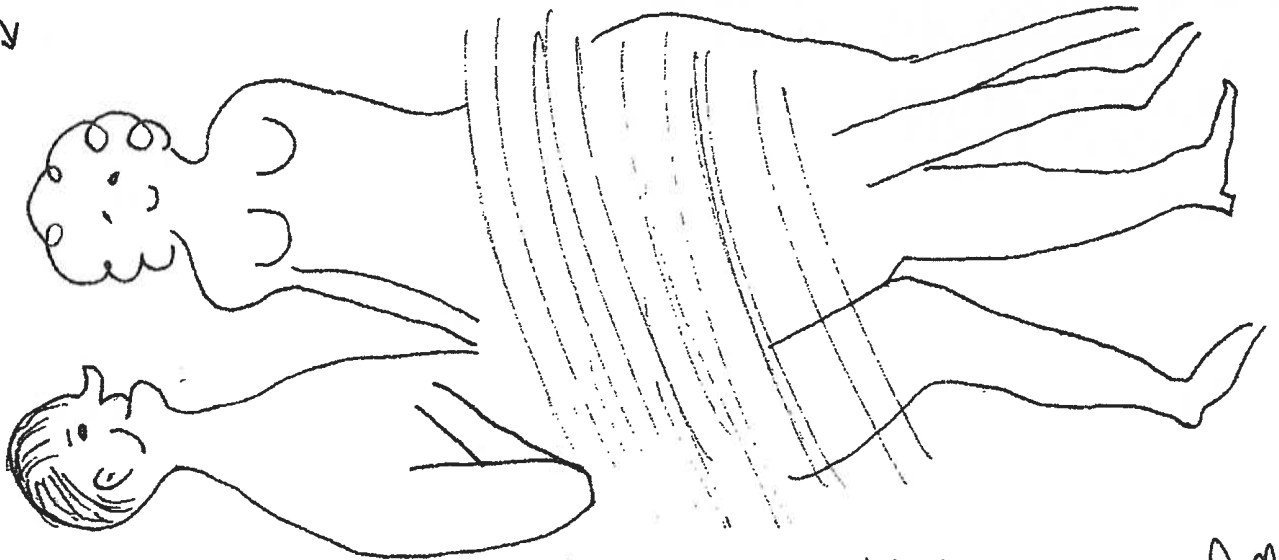

Scratched out

Jm

MAGAGNA SHEEP Shed

BEAM 34

Floyd P. Fruyung  
June 21-1938  
Cleveland  
N. Mex,

Panel 35

May 5 1956  
Melcoo  
Raff  
Jimmie Webb

Beam 34A Blue Chalk

ROMNY WALKER

Panel 35

JII  
4-5-48  
MARGARITO

Grace Sechle  
Kantue  
PA

Sept 7-57

HONDRIO  
A Carved

BUD SECHLE  
KANTUEN  
PA

Sept 7 57

Bobby  
(Porky)  
Loves  
MELBA

May 5-56  
Be i'e  
Mondr  
RATON N Mex

CHARLIE  
CHACON  
GREEN  
RIVER  
Wyo

JOE  
Aguire

Carved

Beam 34

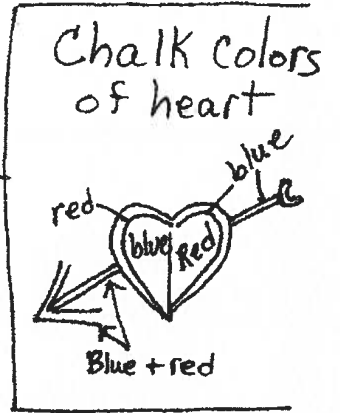
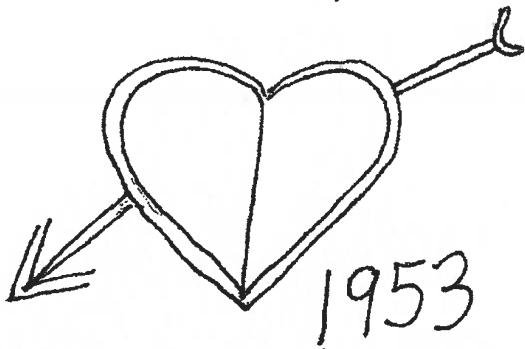

Ben Padilla 5/4/45

Panel 35

Eddie P.  
 Martinez  
 Taos, N Mex  
 5/7/45

Panel 35

6/5/55  
**J.A. RAEL**  
 Grupo Yonko

Panel 36

ROGER MEDINA  
 From SAN PABLO  
 MAY 2 1956

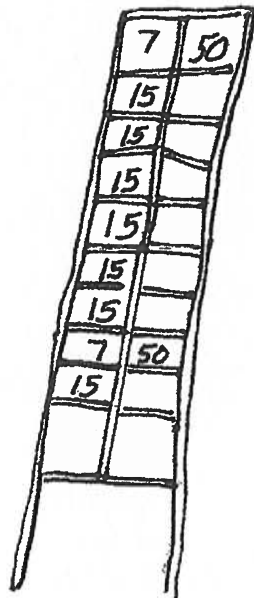
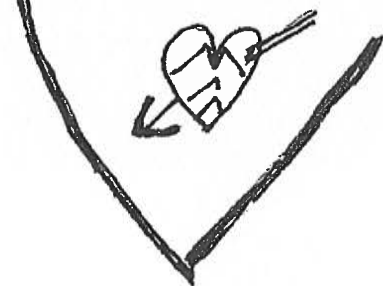

Carved into wood  
Numbers inside

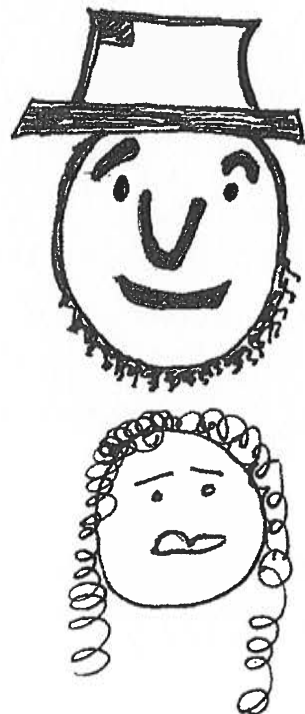

Recorder  
J.M

Ye Old Dining Hall

ENTREE DeLuxe

MULLIGAN DeLuxe

MUCK-AH-HI  
HORSE BEANS

IRISH PATTY  
TORTILAS →

CARYE  
MACK AH RON

LATECHEE

MON-DA-2-2-

→ ADAMS DRINK  
MORMON Fruit

SERIFIT

S → CARIE

Magagna Brothers  
Cookhouse Cabin  
Across from sheep  
shearing shed  
over the window

←  
Majestic Stove  
in Cookhouse

Also a sagebrush  
nest with 3 baby  
Ravens in June, 2004  
+ July 2005

In Bunkhouse



In Bunkhouse  
Names

on back of door:

Ben Romero May 9-192  
Ranches of Taos NM

April 29 1928

Mandy my

W O M

Taos N Me

"Come in quietly and  
softly close the door  
For many a hard boiled man  
was buried beneath this  
floor."

on bunkhouse door:

Leonard Johnson  
May 4 1946

1934 wheat penny  
in doorway of bunkhouse



Manuel L Mica  
LL & nu. N Mexico  
May 4 1950

Fred Herbert

Fred W Buel

Maud Bekan

In Cookhouse on metal plate on  
Majestic Stove:

FELIX CHAVEZ  
6-19-58

MAX YALEI  
TAOS  
1956





MAGAGNA Sheep Shed 2004

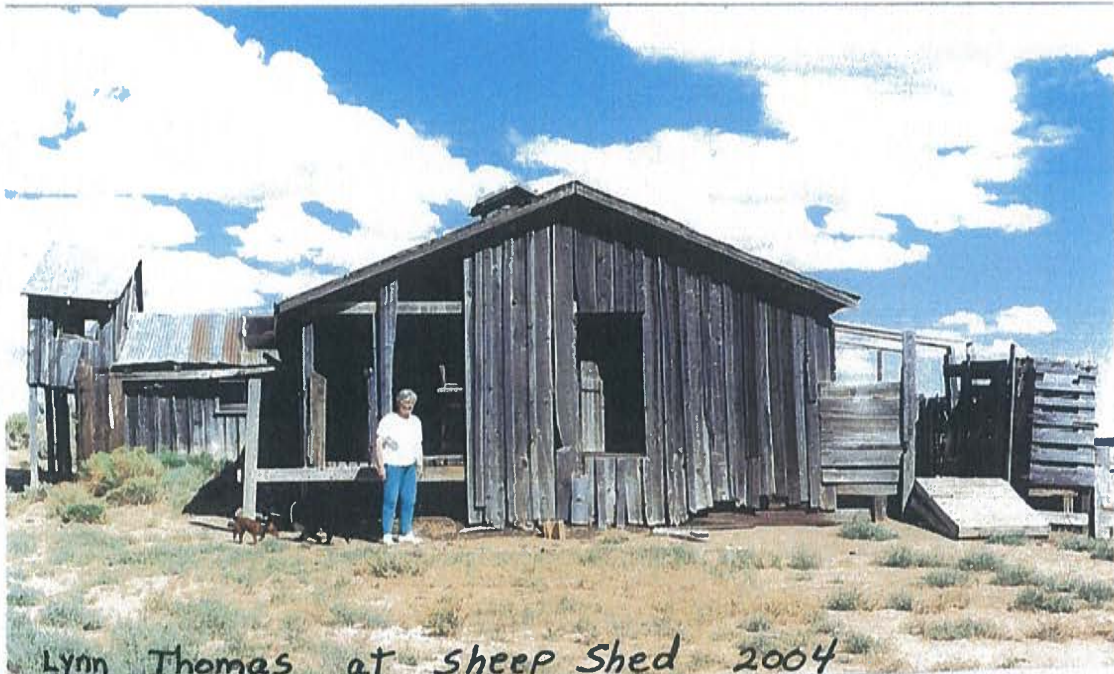

Lynn Thomas at Sheep Shed 2004

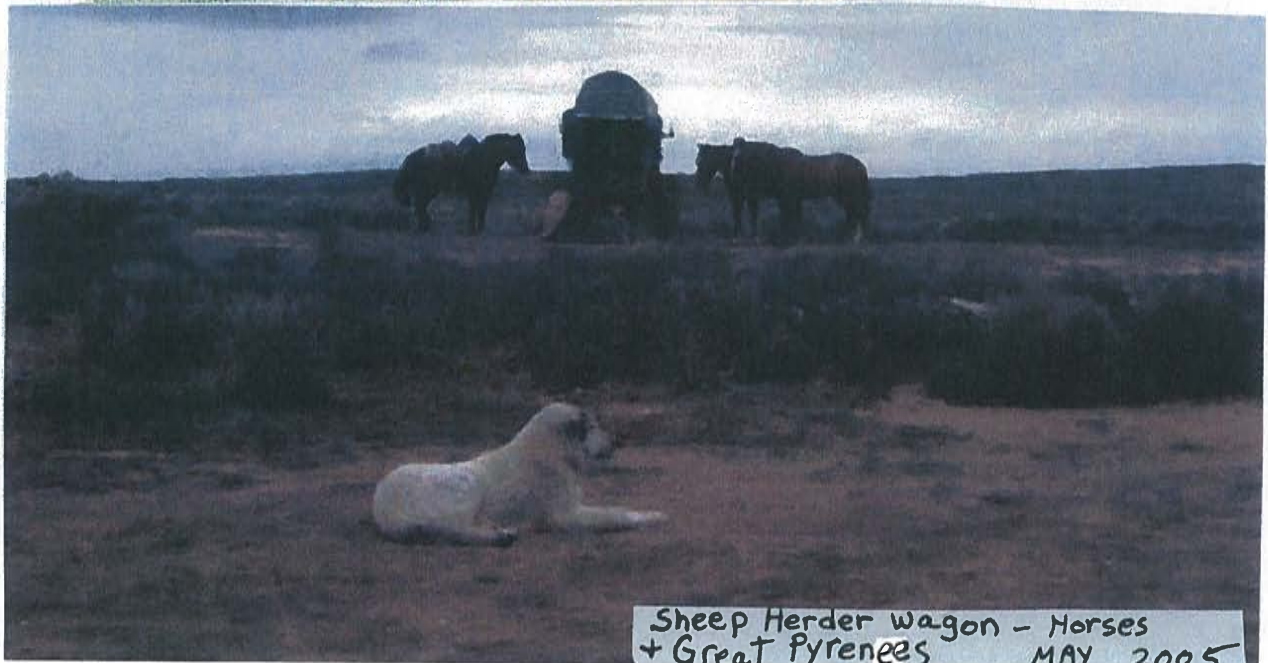

Sheep Herder wagon - Horses  
+ Great Pyrenees MAY 2005





North & EAST side of MAGAGNA Sheep Shed 2004

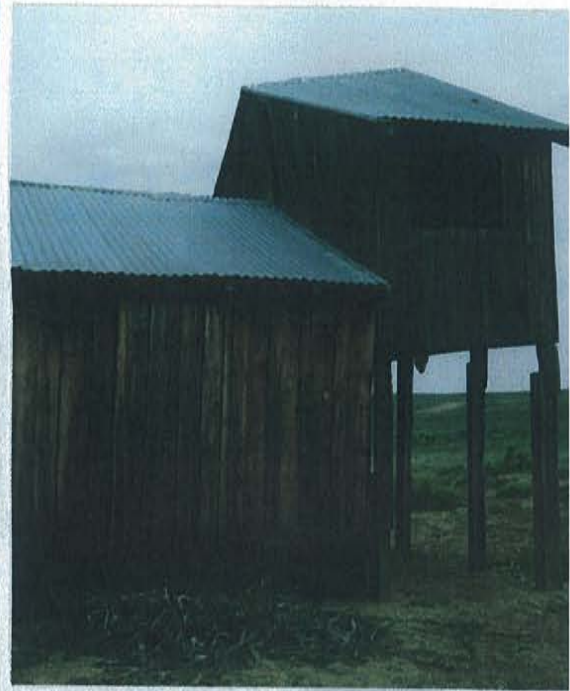

North side of Sheep Shed 2004



South and EAST side of Sheep Shed 2004



Lynn Thomas recording 2004



inside Sheep Shed 2004





Panel 36



Panel 20



Beam 34



Panel 36





THE COMPRESSOR



Sheared Sheep 5-05



Coming out the chutes  
after being sheared  
May 2005

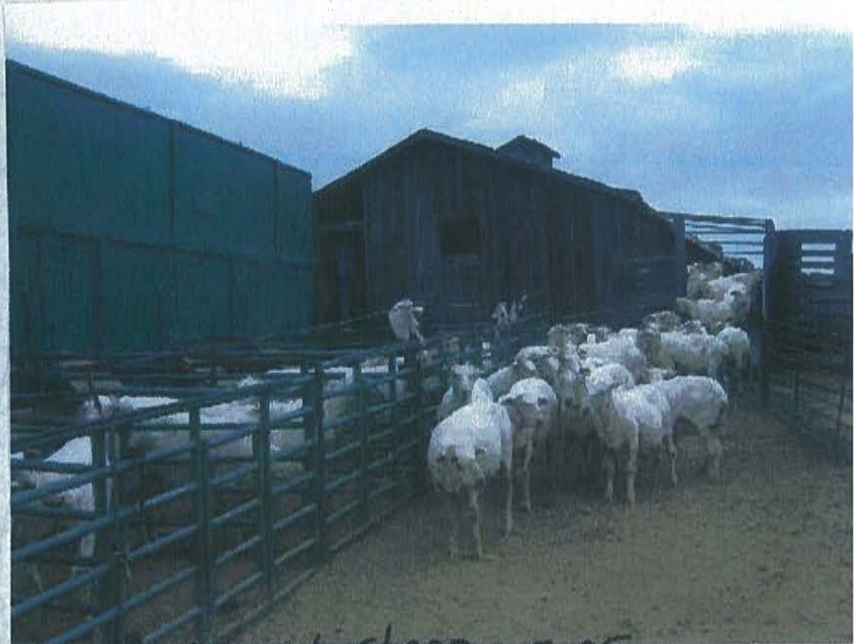

sheared sheep 5-05



Sheared Sheep 5-2005





The "Lead" Sheep 5-05



Sorting the Wool 5-05



Gathering the Wool 5-05

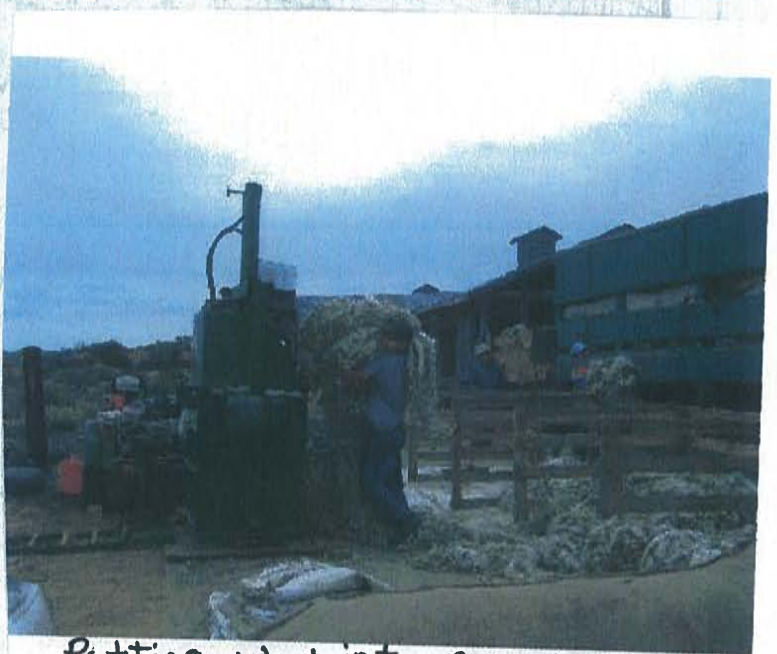

Putting wool into compressor 5/05



Bales of Wool 5-05



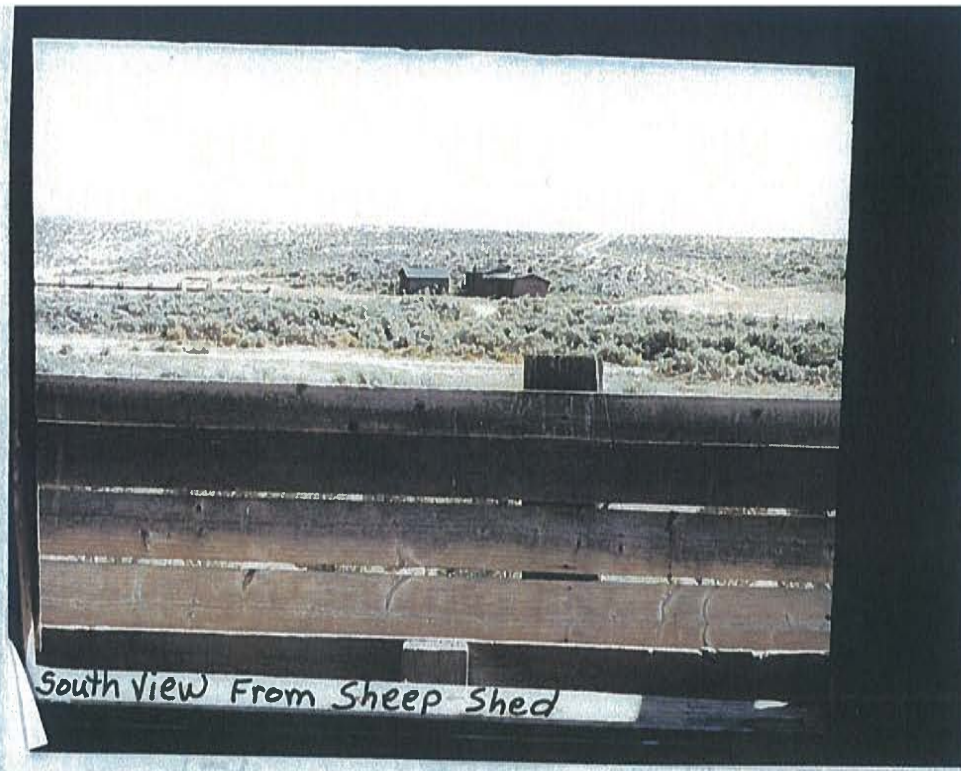

South View From Sheep Shed

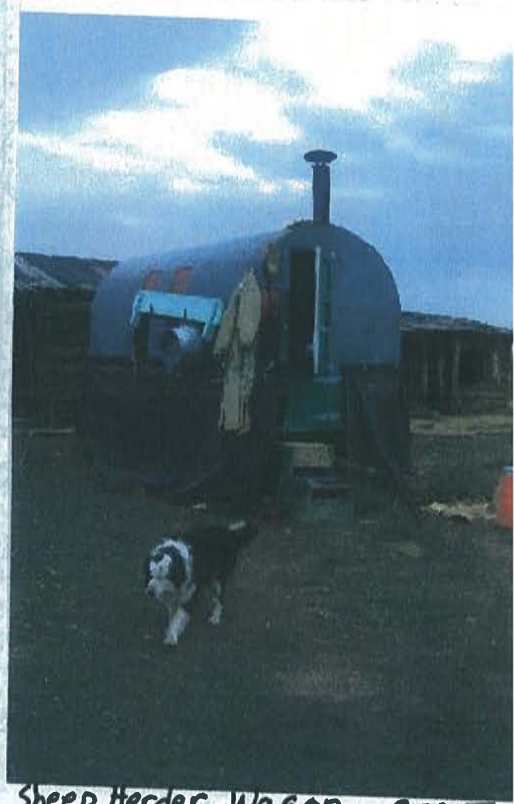

Sheep Herder Wagon 2005

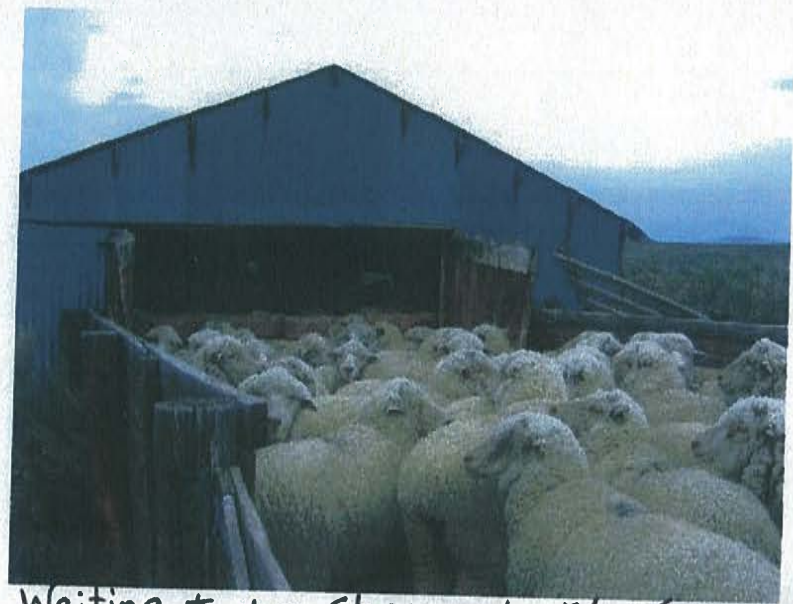

Waiting to be Sheared 5/2005



Waiting in sheep shed MAY 2005

W.B.C. & P.T.A.

J. D. Salazar  
(Bobcat)

69

blue chalk  
↑

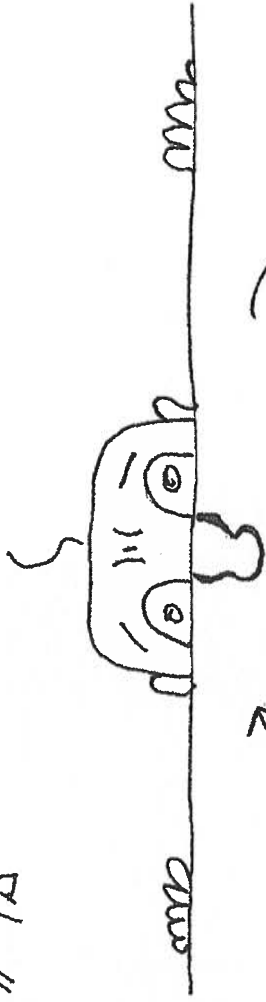
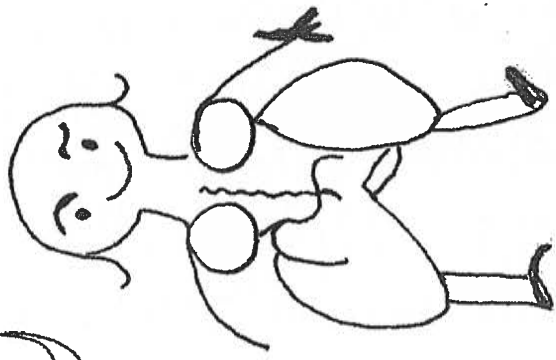

( BEN  
FIGART )

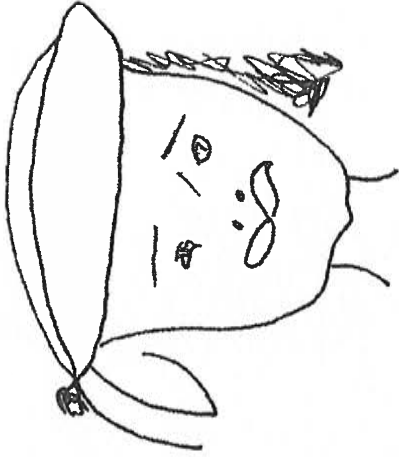

Drawings in the Sheep Shed  
Arambel's Midland Ranch  
10 / 2005  
JM

Writings in The Sheep Shed  
Arambel's Midland Ranch Jmr  
10/2005

James Corral

MAY 5/1953

Echenusia

A ~ Et Davey

April 11 1936

Staney

Uenrutus 1954

Victor

EchARRREN

MAY 2-1954

May 9<sup>o</sup> 1944

Ben Gordova

Rock Springs

Sandy Cordova

San Cristobal New Mexico

Cecelia YedinaK  
Virginia  
J. Johnnie  
MAY

FLOYD

LarraBaster  
LarraBaster  
8<sup>th</sup> 1938

Matijine

Arambel's Midland Ranch  
Sheep Shed 10/2005  
Jan